

DISTRICT	COUNTY	ROUTE	SECTION	SHEET
6-0	DELAWARE	491	100	3 OF 5
CONCORD, BETHEL, UPPER & LOWER CHICHESTER TOWNSHIPS				
REVISIONS				
DATE BY				

TRAFFIC CONTROL PLAN
DETOUR PLAN
PHASE I STAGE 1
PHASE I STAGE 2
PHASE I STAGE 3

DETOUR FOR NAAMANS CREEK ROAD (S.R. 0491)
 WEST OF FOULK ROAD (S.R. 0261)

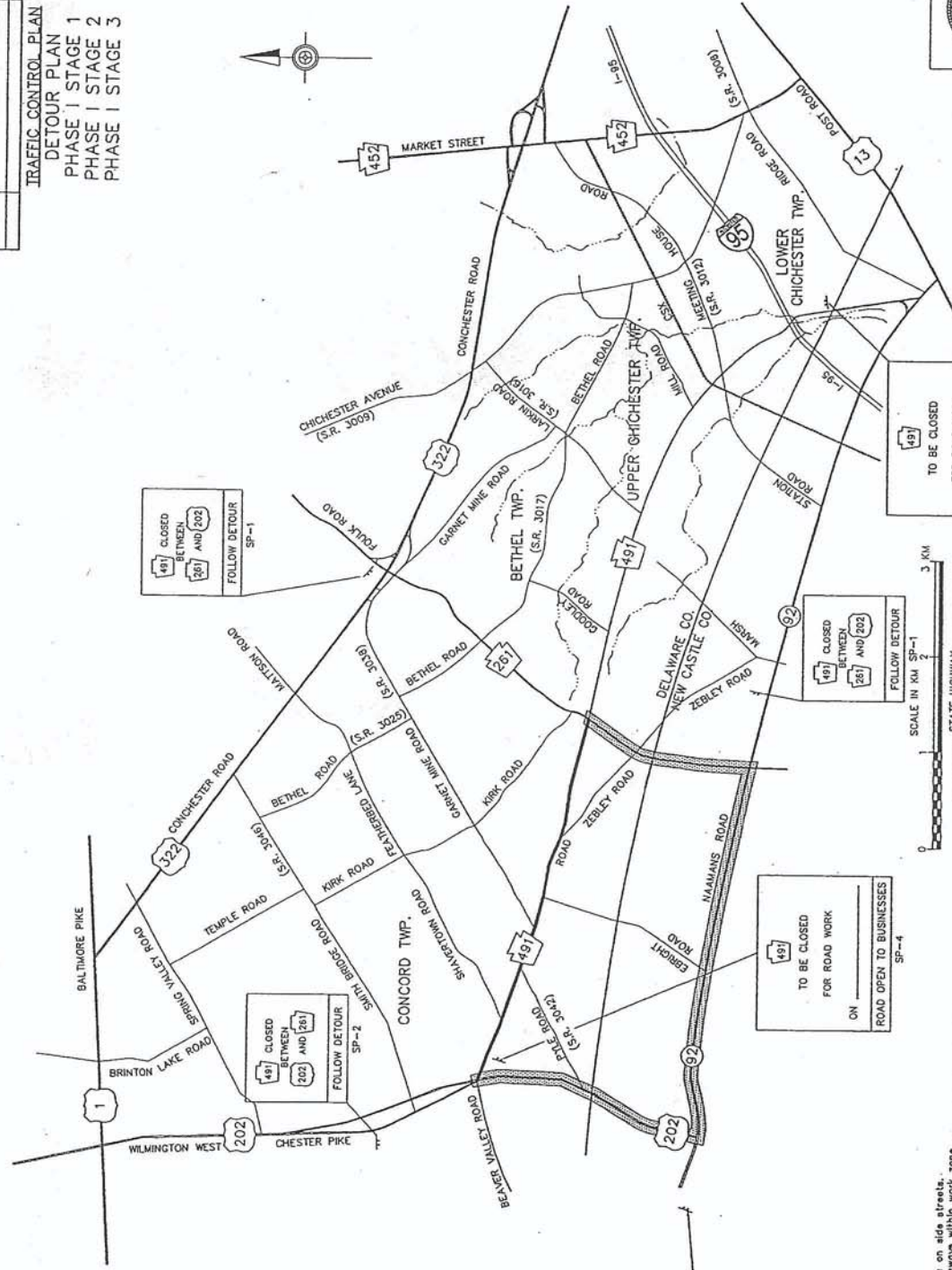

491 CLOSED BETWEEN 202 AND 202
 FOLLOW DETOUR
 SP-1

491 CLOSED BETWEEN 202 AND 261
 FOLLOW DETOUR
 SP-2

491 CLOSED BETWEEN 202 AND 261
 FOLLOW DETOUR
 SP-2

491 TO BE CLOSED FOR ROAD WORK ON ROAD OPEN TO BUSINESSES
 SP-4

491 CLOSED BETWEEN 261 AND 202
 FOLLOW DETOUR
 SP-1

491 TO BE CLOSED FOR ROAD WORK ON ROAD OPEN TO BUSINESSES
 SP-4

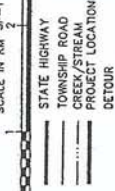

- GENERAL NOTES**
- 1) Maintain through traffic on side streets.
 - 2) Provide access to driveways within work zone.
 - 3) Provide two ten foot lanes during non-working hours for through traffic.

